

GEP DPA POMPBESTURING

Cascade pump control for 2 or 3 pumps



rethinking water



PRODUCT DESCRIPTION

Program of the GEP high end double pump control is written for two or three parallel connected pumps. Control of the pumps is based on pressure. The on and off pressure can be set per pump. At peak load the second and / or third pump automatically switches on.

Operating hours are evenly distributed over the pumps. Pump control also provides a redundant protection. When the system detects a serious fault, the redundancy protection is activated. The affected pump is switched off and an alarm message appears on the LCD display. The system adjusts the parameters in order for the second pump to function in the best possible conditions with optimum operation.

SCOPE

This control is applicable wherever an adjustable water pressure and high operational reliability of two or three pumps is desired.

TECHNICAL DATA

Voltage in V:	1 x 230	Max. flow pump 1 in A:	10
Protection class:	IP55	Max. flow pump 2 in A:	10
Connection IN / OUT:	1 1/4"	Max. flow pump 3 in A:	10
Max. water temperature in ° C:	40	Max. operating pressure in bar:	10
Max. ambient temperature°C:	50	Range in bar:	0.5 - 7
Weight (without cables) in kg:	1.5	Width B1 in mm:	237
Max. volumetric flow in liters / min:	167	Height H in mm:	196
Max. total volume flow in liters / min:	167 + debiet pomp 2/3	Depth D in mm:	178

TECHNICAL DRAWINGS

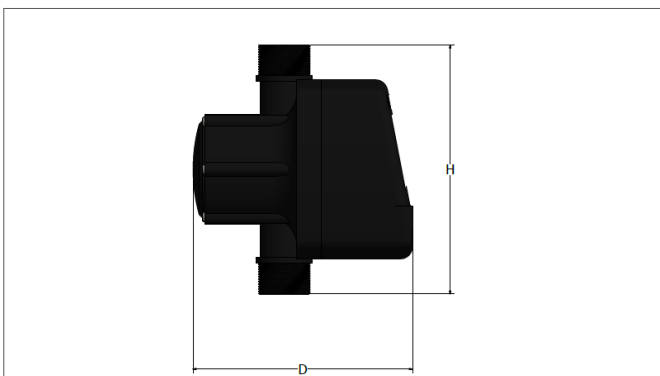

ORDERING INFORMATION

Art nr	NAME	PG
402272	GEP DPA-2 high end kit for double pump	4
402273	GEP DPA-3 high end kit for triple pump	4

